



ADVANCED TECHNICAL DRAWING  
TECHNOLOGY EDUCATION DEPARTMENT  
STEVENS HIGH SCHOOL

ALEX DIAMOND

02-16-12

"SCALE"

"PAGE 1 of 10"

FOUNDATION  
ROBERT DIAMOND  
CLIENT ADDRESS  
CITY, STATE AND ZIP

GAUCHO DESIGNS  
421 CATTLE LANE  
EL PASO, TX  
7492

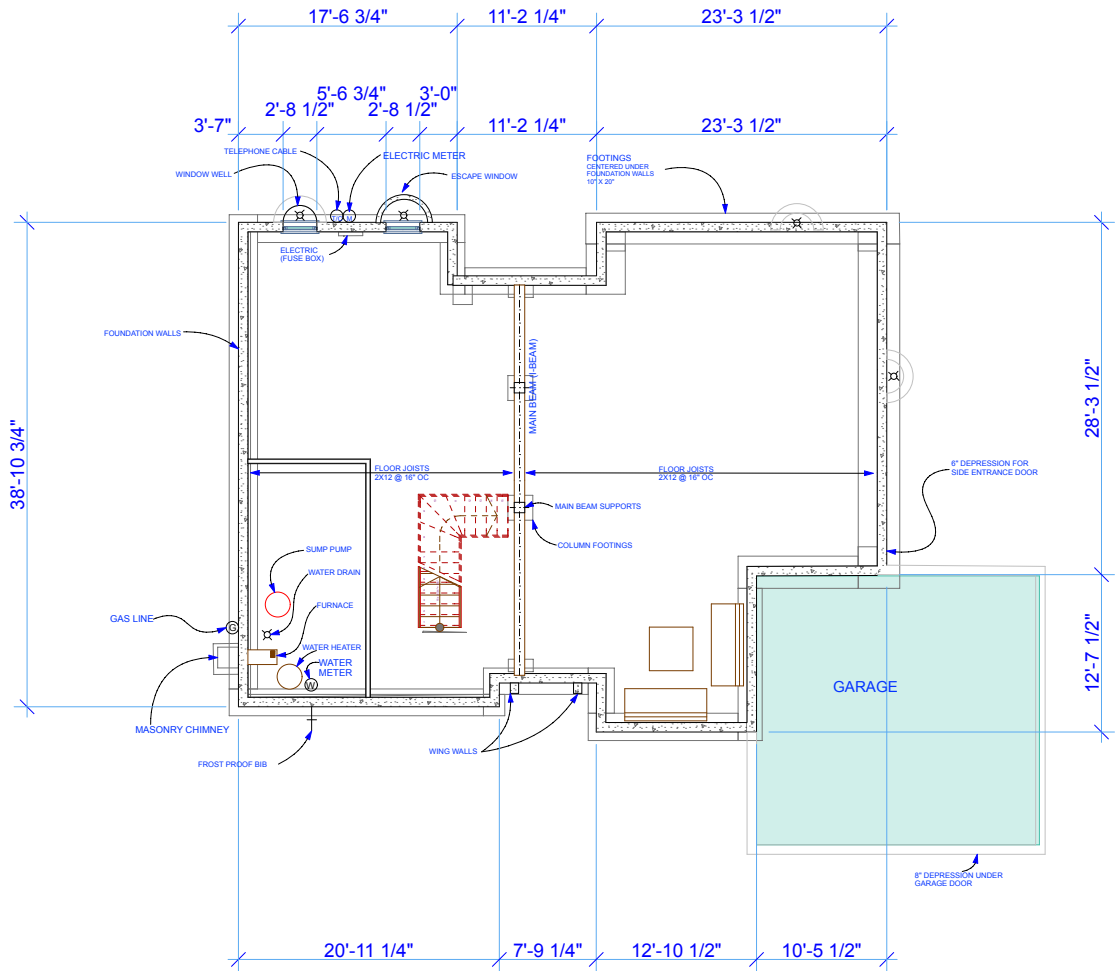

UTILITY DETAILS

- BASEMENT FLOOR - 4" W/ 6 MIL MOISTURE BARRIER
- 1/4" PEA GRAVEL GARAGE FLOOR - 4" POURED CONCRETE
- SLAB WITH 10-10 W/W # 6 @ 6, 1/4" PEA GRAVEL



WINDOW DETAILS